

Plat of Survey

of
Lots 1, 2, and the West 1/2 of 3, all in Block 3
of Interlaken,
a subdivision located in the Southwest 1/4 of Section 11,
Town 3 North, Range 16 East, Town of Sugar Creek,
Walworth County, Wisconsin.

Surveyed for: **Victor Young**
N8612 Birch Road
Elkhorn, Wisconsin. 53121

Movable
Shed
24.1'
16.1'

Tree at corner.
Iron rod set 2.00'
N0°03'13"E of corner.

Movable
Shed
16.1'
10.1'
12.5'

Tax Parcel
GI 00017
Lot 34

Tax Parcel
GI 00010
Lot 6

(100')
S89°49'16"E 99.90'

99.90'
(100')

Block 3

Lot 1

Lot 2

Lot 3

Lot 4

Tax Parcel
GI 00009
0.229 Acre
9,992 Sq.Ft.
(10,000 Sq.Ft.)

Tax Parcel
GI 00009A

(100')
N0°02'39"E 100.03'

95.03'
N0°03'13"E 100.03'

(40') (40')
S89°49'16"E 99.88'

99.88'

(40')
Tree at corner.
Iron rod set 5.00'
N0°03'13"E of corner.

Bearings reference to the Map of Interlaken.
Birch Road (50' Wide)

Park Drive (50' Wide)

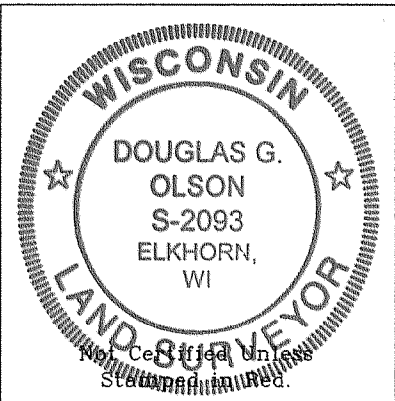

Copyright c 2007 by Jensen & Olson Land Surveying, LLC.

All rights reserved. No part of this survey plat may be reproduced or transmitted in any form by any means - graphic, electronic, or mechanical, including photocopying, tracing, or information storage and retrieval systems - without permission in writing from Douglas G. Olson, Jensen & Olson Land Surveying, LLC.

I hereby certify that I have surveyed the above described property and the map hereon is correct to the best of my professional knowledge and belief and shows the size and location of the property, its exterior boundaries, the location and dimensions of all visible structures thereon, boundary fences, apparent easements and roadways and visible encroachments, if any.

This survey is made for the exclusive use of the present owners of property, and also those who purchase, mortgage or guarantee title thereto, within one year from the date hereof.

Douglas G. Olson
Wisconsin Registered Land Surveyor - 2093

Notes: 1) This survey plat is not certified unless signed and sealed in red ink.

2) This survey is subject to Wisconsin lien laws. This Plat of Survey is the notice of intent to file lien. Lien waiver required.



Legend

- Found Concrete Monument
- Found Iron Pipe
- Found Iron Rod, 1 3/16" dia.
- Found Iron Rod, 3/4" dia.
- () Recorded Information
- Utility Pole
- Asphalt Surface
- Gravel Surface
- Concrete Surface
- Set Iron Rod, 3/4" dia.

Jensen & Olson Land Surveying, LLC

45 South Wisconsin Street P.O. Box 322
Elkhorn, Wisconsin. 53121
Telephone: (262) 723-3434
Facsimile: (262) 723-8044

Scale: 1" = 20'



Survey date: March 16, 2007.
Revisions:

Sheet 1 of 1 Sheets.

Job Reference Number:

2006.132

GI-9

316-1936